



BEST: TO TEST!

NORKA

LED LUMINAIRES FROM NORKA

High quality, low price,
robust and weatherproof

INDEX OF PAGES

INTRO

INDEX OF PAGES	Cover	MAGNON® LUMINAIRE RANGE	2	NORKA QUALITY MADE IN GERMANY	4
AREAS OF APPLICATION	Cover	THE PRINCIPLE OF SHORT GASKETS	3	NORKA IS WORTH THE INVESTMENT	5



CEILING MOUNTED LUMINAIRES

6



PL-1000-01 **10**



PL-2000-01 **12**



PL-3000-01 **14**



FLOODLIGHTS

16



SL-1000-01 **20**



TUBULAR LUMINAIRES

22

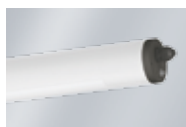

RL-1000-01 **26**



TECHNICAL NOTICES

28

IMPRINT	28
REPRESENTATIVES / WORLDWIDE	Cover



AREAS OF APPLICATION



Application	PL-1000-01	PL-2000-01	PL-3000-01	SL-1000-01	RL-1000-01
Architectual				■	■
Public transport	■	■		■	■
Illumination of façades	■	■		■	
Technical rooms	■	■			
Agriculture and animal husbandry			■	■	
Car parks	■	■		■	■
Production	■	■		■	
Underpasses					■
Car wash	■	■			■
Special features					
IP 65	■	■	■	■	■
IP 69K					■
Can be swivelled 90°	■	■	■	■	■
Can be swivelled 120°				■	
Ammonia resistant			■		
Variable adjustment of luminous flux		■			
Suitable for intensive cleaning using high-pressure-cleaners					■

BEST: TO TEST!

A high-resolution photograph of a lush green lawn. The grass is a mix of fine blades and small, rounded-leafed plants, creating a dense, textured appearance. A few small white daisies with yellow centers are scattered throughout, most notably one in the upper left quadrant. The lighting is even, highlighting the vibrant green of the vegetation.

EXTRAORDINARILY

ROBUST

AND

**WEATHER-
PROOF**



QUALITY CHOICE COMPETITIVELY PRICED

The MAGNON® luminaire range represents a clear choice of products featuring all of the quality characteristics of a NORKA luminaire.

The versatility of this product range has been optimised — making selection and planning easier.

All luminaires in the MAGNON® range are subject to the same development, production, and testing processes as all other NORKA products and are

manufactured from the same high specification materials. MAGNON® products feature above average high quality and durability compared to the competition. Uniform standards and no bespoke components mean short delivery times can be realised. The result: an optimised high quality product portfolio competitively priced.

5
year
guarantee

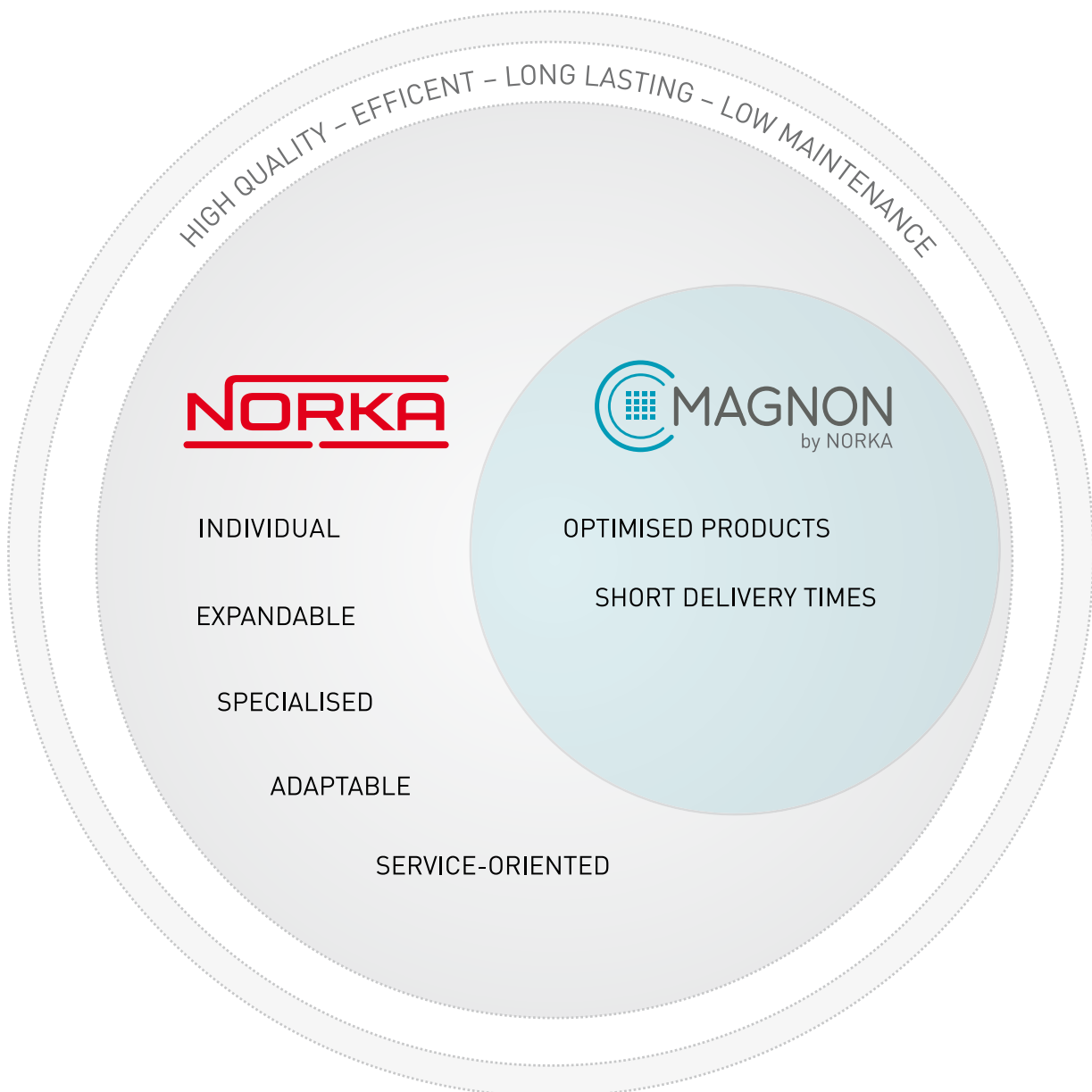

THE PRINCIPLE OF SHORT GASKETS

COMPLETELY WEATHER-RESISTANT

Typical NORKA – that is a good description for this sophisticated luminaire design. These luminaires have been offering as few points of entry as possible for moisture, dust and insects for over 65 years. This is achieved by special closure techniques with minimum gasket lengths.

The longer a gasket system, the greater the possibility of a leak or mechanical damage. Conventional moisture-proof luminaires achieve tightness through the adaptiveness of the gasket material and the uniformly applied pressure between luminaire cover and housing. The pressure is usually generated across the entire length using quick release closures requiring no tools.

Extreme requirements such as cleaning processes with chemicals or acidic or alkaline atmospheres quickly corrode the materials. Materials of lesser quality age more quickly or they oxidise and become brittle.

NORKA exclusively uses high quality gaskets made of non-ageing, form-retaining silicone/synthetic rubber. The housing materials and gasket mounts are perfectly adapted to the corresponding gaskets and applications. A short gasket system can create a higher gasket pressure to achieve safer, more permanent, and completely weather-resistant gasket.

NORKA LUMINAIRE, 1.2 M LONG WITH SHORT GASKET GASKET LENGTH APPROX. 0.4 M

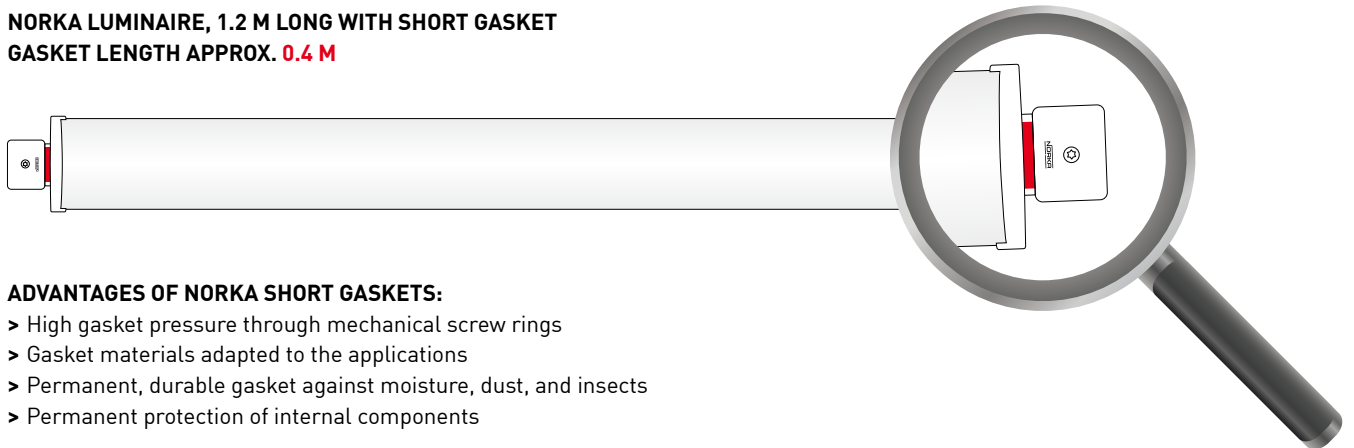

ADVANTAGES OF NORKA SHORT GASKETS:

- > High gasket pressure through mechanical screw rings
- > Gasket materials adapted to the applications
- > Permanent, durable gasket against moisture, dust, and insects
- > Permanent protection of internal components

CONVENTIONAL DIFFUSER LUMINAIRE, 1.2 M LONG GASKET LENGTH APPROX. 2.6 M

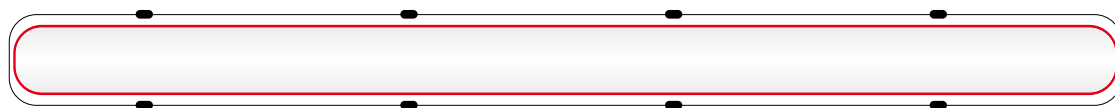

DISADVANTAGES OF DIFFUSER LUMINAIRES WITH LONG GASKETS:

- > Gasket is displaced after opening
- > Thin wall thickness
- > Sensitive quick-mounting pressure cap
- > Unstable overall luminaire

LUMINAIRES WITH HIGH IP AND IK PROTECTION RATING ARE OUR STANDARD

NORKA – the solutions provider.

For more than 65 years, NORKA has developed and manufactured long lasting, efficient lighting applications.

Luminaires with a high protection rating, which work reliably and can permanently withstand exposure to tough ambient conditions, such as heat, cold, water jets, aggressive dusts, corrosive liquids, hazardous gases, and strong vibrations.

“Made in Germany” is the aspiration which motivates us in our day-to-day operations.

We combine a wealth of experience with permanent technical innovation. We continuously develop our extensive range of luminaires for special applications.

Using state-of-the-art production methods and our own laboratory equipped to VDE standards, we can guarantee ultimate product quality.

During development of our luminaires, we focus on both the investment and operating costs throughout the entire life cycle (Total Cost of Ownership), i.e. the expenditure for mounting, operation, and maintenance.

Thanks to their durability and energy efficiency, NORKA LED luminaires will offer you the ultimate, reliable investment.



> Water jet testing in the NORKA laboratory



> Impact testing in the NORKA laboratory

NORKA IS WORTH THE INVESTMENT

57% ENERGY SAVING WITH LED LUMINAIRE COMPARED TO T8 DIFFUSER LUMINAIRE

EXAMPLE CALCULATION:

Room L × B: 5 × 10 m mounting height: 2.7 m, nominal illumination level: 300 lx

	T8 DIFFUSER LUMINAIRE	PL-1000-01, M1200, PMMA Transopal® (impact strengthened)
Manufacturer	Competitor	NORKA
Quantity	6	4
Version + components	58 W T8, ECG 5200 lm	medium beam 4660 lm
System power	64 W	41 W
Total luminous flux of all luminaires	31200 lm	18640 lm
Total power	384 W	164 W
Total power per surface (1102.00 m²)	7.68 W/m² (2.54 W/m²/100 lx)	3.28 W/m² (1.09 W/m²/100 lx)
Average illumination level Em	303 lx	301 lx
Uniform lighting U ₀ Emin/Em	0.53	0.51

Energy saving
compared to
competitor

0%

57%

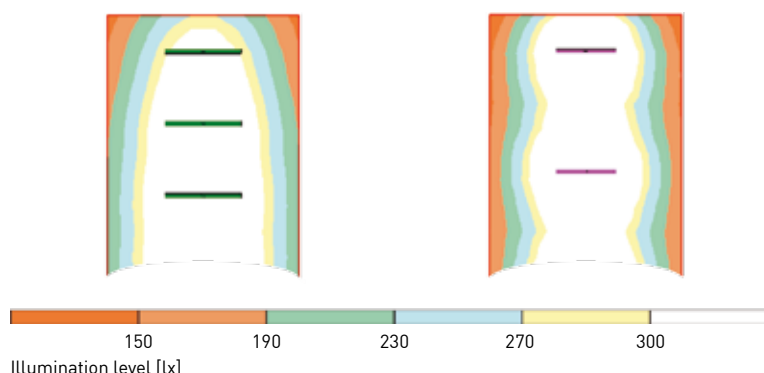



EXTRAORDINARILY WEATHERPROOF

CEILING MOUNTED LUMINAIRES

The MAGNON® PL range features a LED reflector with a particularly wide swivel range reflector.

Mounted on the wall or ceiling, the reflector can be swivelled up to $2 \times 90^\circ$ in any position.

This allows for applications in small workshops, as forecourt lighting above gates and doors, or between wooden

constructions, for example, carports. For industrial applications with high requirements when it comes to the flexibility of luminous flux, the version with adjustable luminous fluxes can be used.

Different luminous fluxes can be set, which means that installers are provided with great flexibility, especially in large-scale building projects where

there are different lighting requirements.

An ammonia resistant version is especially robust and long lasting when used in stables.

BEST: TO TEST!





Feuerwehr
Einfahrt freihalten

CEILING MOUNTED LUMINAIRES

INDEX

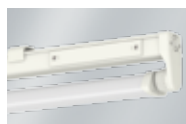

PL-1000-01 10



PL-2000-01 12



PL-3000-01 14

PL-1000-01

LED

IP 65

CE

F

D

IK 04

PMMA

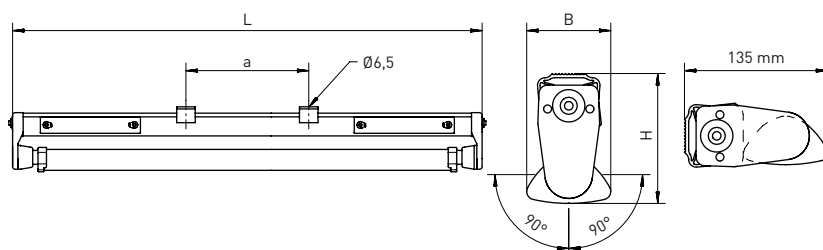

medium beam

Lamp	Version	L	B	H	a	max. weight
LED	m1200	1255 mm	80 mm	123 mm	600 ± 40 mm	2.8 kg
LED	m1500	1555 mm	80 mm	123 mm	900 ± 40 mm	3.4 kg

AREAS OF APPLICATION

Polymer luminaire with LED lamps. For use in industrial and public applications and areas with special safety requirements.

HOUSING

Weather-proof and UV-resistant luminaire housing made of fibreglass reinforced polymer, like RAL 9010. Unrestricted use for indoor and outdoor areas according to protection rating IP 65. Thermally separated lamp chamber and driver chamber. Short gasket system consisting of age resistant, form retaining silicone/synthetic rubber.

LIGHTING TECHNOLOGY

2 × 90° swivel reflector tube made of PMMA Transopal® (impact strengthened) with internal aluminium reflector (MIRO-SILVER®).

ELECTRICAL CONSTRUCTION

Luminaire ready for mounting and installation. Built-in driver, 230 V AC/DC. Two side access covers, two cable entries M20 on the face side and 3 × 1.5 mm² through wiring.

MOUNTING

Individual or row mounting. Ceiling or wall fixation using two polymer mounting clamps with variable mounting distance.

Permanent ambient temperature -25 °C to +35 °C. **L70 B50 > 50,000 h.**

PL-1000-01, PMMA TRANSOPAL® (IMPACT STRENGTHENED), MEDIUM BEAM

Version	Colour temperature/K	Luminous flux*/lm	System power**/W	NORKA article no.
m1200	□ 840/4000	4660	41	345 480 44 21
m1500	□ 840/4000	5800	51	345 680 34 21

* Luminous flux of the luminaire at 55 °C on the T_c point of the LED
 ** Rounded performance ratings

PL-1000-01 CONE DIAGRAMS

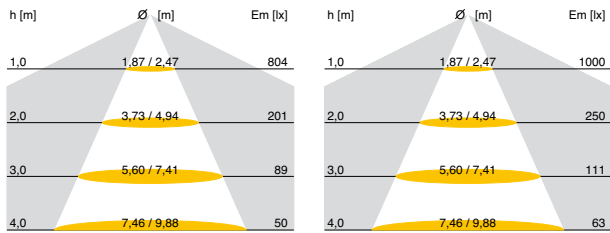

PL-1000-01, m1200, 4660 lm
 PMMA Transopal® (impact strengthened)
 medium beam
 Article no. 345 480 44 21

PL-1000-01, m1500, 5800 lm
 PMMA Transopal® (impact strengthened)
 medium beam
 Article no. 345 680 34 21

SAMPLE APPLICATIONS OF SWIVEL RANGE

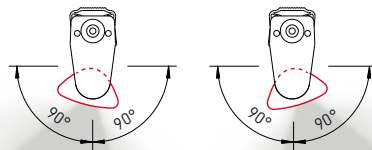

Extreme
swivel angle

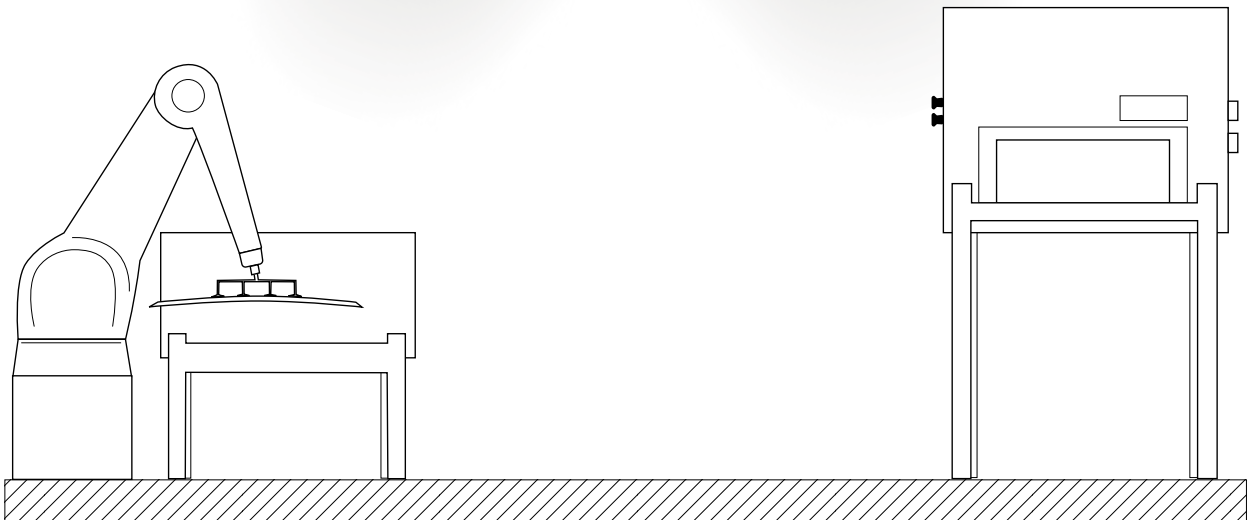

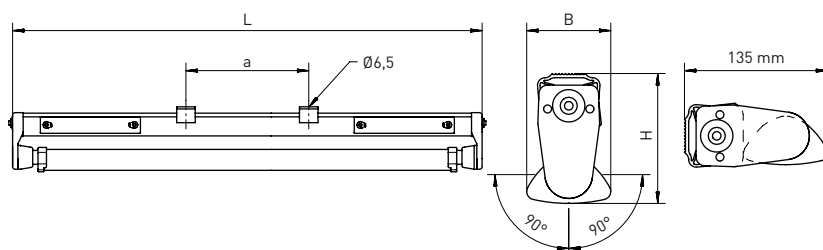

medium beam

Lamp	Version	L	B	H	a	max. weight
LED	m1200	1255 mm	80 mm	123 mm	600 ± 40 mm	2.8 kg
LED	m1500	1555 mm	80 mm	123 mm	900 ± 40 mm	3.4 kg

AREAS OF APPLICATION

Polymer luminaire with LED lamps, variable adjustment of luminous flux in three stages.
For use in industrial and public applications and areas with special safety requirements.

HOUSING

Weather-proof and UV-resistant luminaire housing made of fibreglass reinforced polymer, like RAL 9010. Unrestricted use for indoor and outdoor areas according to protection rating IP 65. Thermally separated lamp chamber and driver chamber. Short gasket system consisting of age resistant, form retaining silicone/synthetic rubber.

LIGHTING TECHNOLOGY

Reflector tube that can be swivelled 2 × 90°, made of PMMA Transopal® (impact strengthened) with internal aluminium reflector (MIRO-SILVER®).

ELECTRICAL CONSTRUCTION

Luminaire ready for mounting and installation. Built-in driver, 230 V AC/DC. Two side access covers, one of which has an integrated DIP switch; two face side cable entries M20 and 3 × 1.5 mm² through wiring.

MOUNTING

Individual or row mounting. Ceiling or wall fixation using two polymer mounting clamps with variable mounting distance.

Permanent ambient temperature -25 °C to +35 °C. **L70 B50 > 50,000 h.**

PL-2000-01, PMMA TRANSOPAL® (IMPACT STRENGTHENED), MEDIUM BEAM

Version	Colour temperature/K	Luminous flux*/lm	System power**/W	NORKA article no.
m1200	□ 840/4000	3100 - 4660	29 - 41	347 480 34 21
m1500	□ 840/4000	3900 - 5800	35 - 51	347 680 34 21

* Luminous flux of the luminaire at 55 °C on the T_C point of the LED
 ** Rounded performance ratings

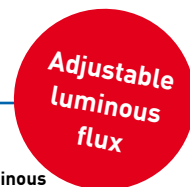

PL-2000-01 LUMINOUS FLUX TABLE

Version	Adjustable system power**/W	Actual luminous flux/lm	Version	Adjustable system power**/W	Actual luminous flux/lm
m1200	29	3100	m1500	35	3900
	35	3900		43	4900
	41	4660		51	5800

** Rounded performance ratings
 Standard luminous flux, corresponds to the luminous flux of a luminaire with T8 of the same length

- > Housing with easy-open access covers. High level of tightness, protected against water jets according to IP 65.

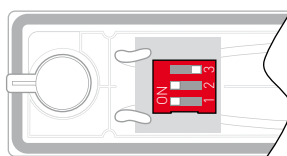

> NOTE:

The luminous fluxes of individual versions can be adjusted individually by means of DIP switch; this is integrated in the access cover and easy to access.
 The luminaires are preset at the factory with a luminous flux similar to T8 lamps.

PL-2000-01 CONE DIAGRAMS

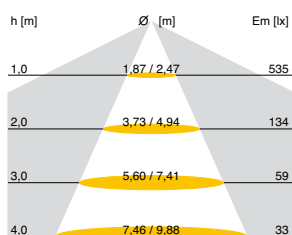

PL-2000-01, m1200, 4660 lm
 PMMA Transopal® (impact strengthened)
 medium beam
 Article no. 347 480 34 21

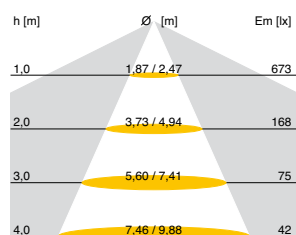

PL-2000-01, m1500, 5800 lm
 PMMA Transopal® (impact strengthened)
 medium beam
 Article no. 347 680 34 21

PL-3000-01

LED

IP 65

CE

F

D

IK 04

PMMA

Ammonia-resistant

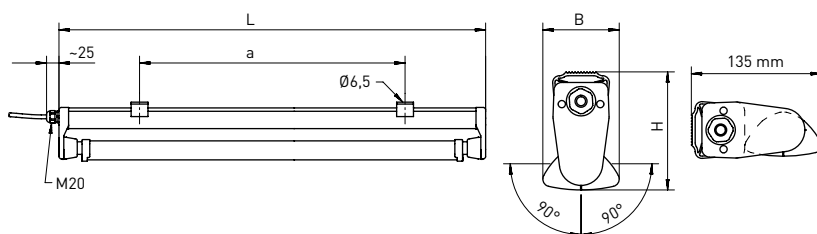

medium beam

Lamp	Version	L	B	H	a	max. weight
LED	m1200	1255 mm	80 mm	123 mm	920 ± 80 mm	2.8 kg
LED	m1500	1555 mm	80 mm	123 mm	1220 ± 80 mm	3.4 kg

AREAS OF APPLICATION

Ammonia resistant polymer luminaire with LED lamps. Can be used in stables or aviaries with high ammonia levels and special safety requirements.

HOUSING

Weather-proof and UV-resistant luminaire housing made of fibreglass reinforced polymer, like RAL 9010. Unrestricted use for indoor and outdoor areas according to protection rating IP 65.

Thermally separated lamp chamber and driver chamber. Short gasket system consisting of age resistant, form retaining silicone/synthetic rubber.

LIGHTING TECHNOLOGY

Reflector tube that can be swivelled 2 × 90°, made of PMMA Transopal® (impact strengthened) with internal aluminium reflector (MIRO-SILVER®).

ELECTRICAL CONSTRUCTION

Luminaire ready for mounting and installation. Built-in driver, 230 V AC/DC. One M20 face side cable gland. Ready for connection via ammonia resistant connecting cable (2 m) 2 × 2.5 mm².

MOUNTING

Single mounting. Ceiling or wall fixation using two polymer mounting clamps with variable mounting distance. Permanent ambient temperature -25 °C to +35 °C. **L70 B50 > 50,000 h.**

PL-3000-01, PMMA TRANSOPAL® (IMPACT STRENGTHENED), MEDIUM BEAM

Version	Colour temperature/K	Luminous flux*/lm	System power**/W	NORKA article no.
m1200	□ 840/4000	4660	41	349 480 34 21
m1500	□ 840/4000	5800	51	349 680 34 21

* Luminous flux of the luminaire at 55 °C on the T_c point of the LED
 ** Rounded performance ratings

PL-3000-01 CONE DIAGRAMS

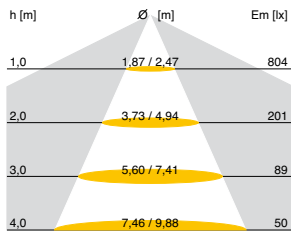

PL-3000-01, m1200, 4660 lm
 PMMA Transopal® (impact strengthened)
 medium beam
 Article no. 349 480 34 21

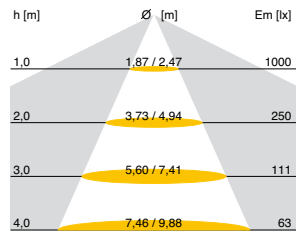

PL-3000-01, m1500, 5800 lm
 PMMA Transopal® (impact strengthened)
 medium beam
 Article no. 349 680 34 21





UNCOMPROMISINGLY WEATHERPROOF & VERSATILE

FLOODLIGHTS

The compact floodlight SL-1000-01 is suitable for easy ceiling and wall mounting.

The luminaire housing is made of extremely weather-resistant polymer and cast aluminium and can be used outdoors without any restrictions.

The luminaire is used in factory buildings, as lighting under canopies, for transport areas, or for illuminating building façades.

BEST: TO TEST!





FLOODLIGHTS

INDEX



SL-1000-01 **20**

SL-1000-01

LED



Can be
swivelled
+
energy
efficient

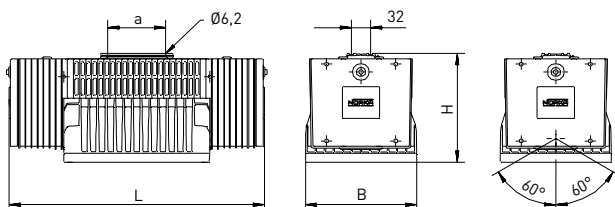

wide beam

Lamp	Version	L	B	H	a	max. weight
LED array	Floodlight	424 mm	185 mm	180 mm	96 mm	4.7 kg

AREAS OF APPLICATION

Floodlight with LED array. For use in industrial facilities with different mounting heights, for illuminating buildings and advertising spaces and for car park illumination, among others.

HOUSING

Luminaire housing made of weather-proof, UV-resistant, fibreglass-reinforced polymer, black. Reflector housing made of cast aluminium, swivelling and locking up to 120°. Thermally separated lamp and driver chamber. Gasket system made of age resistant, form retaining silicone/synthetic rubber. Protection rating IP 65, protection class II.

LIGHTING TECHNOLOGY

LED arrays in a neutral white colour temperature. Cover screen made of safety glass with internal aluminium reflector made of MIRO-SILVER®.

ELECTRICAL CONSTRUCTION

Luminaire ready for mounting and installation. Built-in driver, supply voltage 230-240 V 0, 50-60 Hz Suitable for emergency lighting. Two face side cable entries M20. One additional, concealed cable entries M20 at rear.

MOUNTING

Ceiling or wall fixing using aluminium mounting clamp. Permanent ambient temperature -25 °C to +40 °C. **L70 B50 > 50,000 h.**

SL-1000-01 WITH COVER SCREEN MADE OF SAFETY GLASS, WIDE BEAM

Version	Colour temperature/K	Luminous flux*/lm	System power**/W	NORKA article no.
SL-1000-01	□ 840/4000	5370	42	905 070 34 69

* Luminous flux of the luminaire at 55 °C on the T_c point of the LED
 ** Rounded performance ratings

SL-1000-01 ACCESSORIES

Version	NORKA article no.
Eyebolts M6, galvanised steel, for pendant installation (pair)	967 901

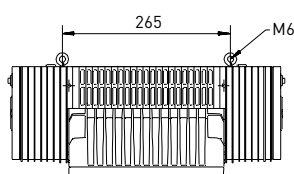

> **Eyebolts M6 (pair)**
 Galvanised steel, for pendant installation,
 Article no. 967 901 (pair)

SL-1000-01 CONE DIAGRAM

h [m]	Ø [m]	Em [lx]
1,0	2,30 / 2,65	843
2,0	4,60 / 5,31	211
3,0	6,90 / 7,96	94
4,0	9,20 / 10,62	53
5,0	11,50 / 13,27	34
6,0	13,80 / 15,92	23

SL-1000-01, 5370 lm
 Cover screen single pane safety glass,
 medium beam
 Article no. 905 070 34 69

1:1 replacement in practice

LED	Conventional	Energy saving*
SL-1000-01	70 W HIT-CE	53%

* The better light guiding significantly increases the light output ratio (LOR) of the LED luminaire over a HIT-CE lamp.





AMAZINGLY ROBUST

TUBULAR LUMINAIRES

A wide range of applications can be covered in architecture by the RL-1000-01 tubular luminaire.

The luminaire is perfect for emphasising building contours as well as to illuminate rooms with low ceiling

heights, for example, underpasses or car park buildings.

The high protection rating IP 69K means the luminaire can be completely cleaned with a high-pressure cleaner and hot water.

The variable mounting distances make mounting very easy.

BEST: TO TEST!



TUBULAR LUMINAIRES

INDEX





RL-1000-01 26

RL-1000-01

LED

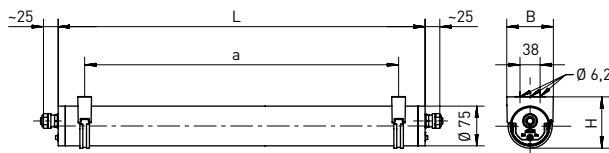
IP 65 IP 66 IP 68 20m IP 69K CE F D IK 07 PMMA



 medium beam

Lamp	Version	L	B	H	a	max. weight
LED	m1200	1410 mm	88 mm	97 mm	1310 ± 25 mm	4.0 kg
LED	m1500	1710 mm	88 mm	97 mm	1610 ± 25 mm	4.9 kg

AREAS OF APPLICATION

Tubular luminaire with LED lamps. For use in industrial applications, in work pits used for maintenance and repair work and for decorative indoor and outdoor lighting.

HOUSING

Polymer luminaire tube (Ø 75 mm) with two quick-mounting pressure caps and protection against unauthorised opening. Resistant to pressurised water to 20 m according to protection rating IP 68 20 m. Unrestricted use for indoor and outdoor areas in compliance with IP 65 and IP 66.

Suitable for intensive cleaning processes using high-pressure-cleaners due to high protection rating IP 69K.

LIGHTING TECHNOLOGY

Luminaire tube made of PMMA Transopal® (impact strengthened), homogeneously illuminated.

ELECTRICAL CONSTRUCTION

Luminaire ready for mounting and installation. Built-in driver, 230 V AC/DC. Two cable glands on face side (M20) and 3 × 1.5 mm² through wiring.

MOUNTING

Individual or row mounting. Ceiling or wall fixing using two mounting clamps made of stainless steel/black polymer with variable mounting distance, including protections against unauthorised opening.

Permanent ambient temperature -25 °C to +30 °C. **L70 B50 > 50,000 h.**

RL-1000-01, PMMA TRANSOPAL® (IMPACT STRENGTHENED), MEDIUM BEAM

Version	Colour temperature/K	Luminous flux*/lm	System power**/W	NORKA article no.
m1200	□ 840/4000	4660	41	325 480 34 21
m1500	□ 840/4000	5800	51	325 680 34 21

* Luminous flux of the luminaire at 55 °C on the T_c point of the LED
 ** Rounded performance ratings

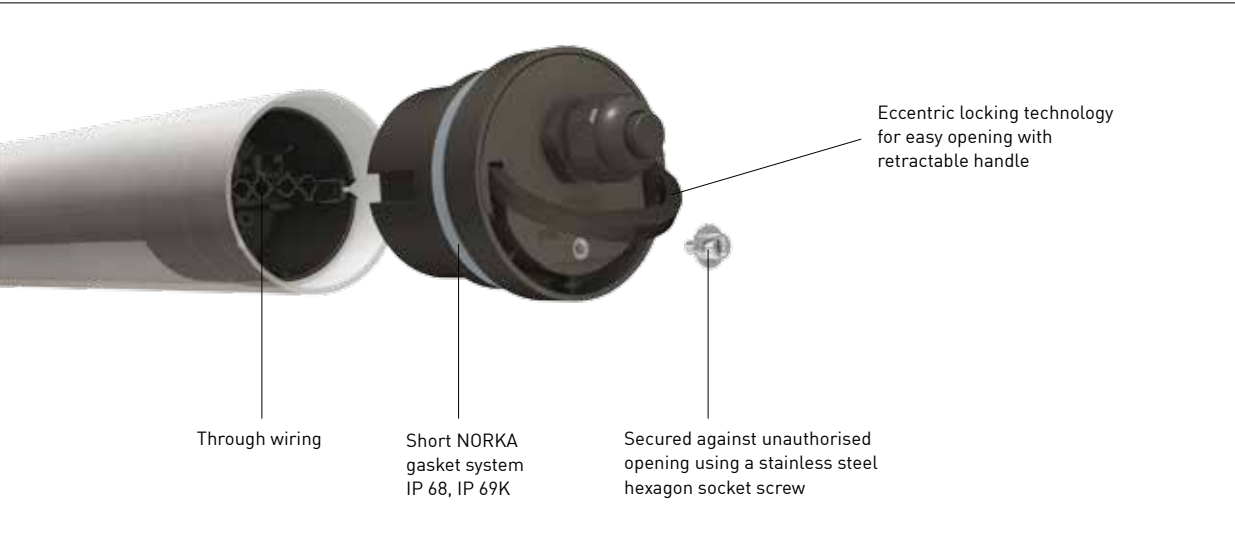

> RL-1000-01 quick-mounting pressure cap



> Mounting clamps for RL-1000-01
 Stainless steel/polymer black,
 included

RL-1000-01 CONE DIAGRAMS

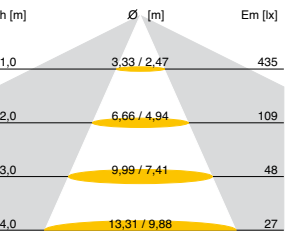

RL-1000-01, m1200, 4660 lm
 PMMA Transopal® (impact strengthened)
 medium beam
 Article no. 325 480 34 21

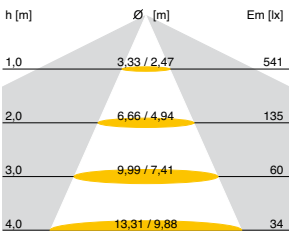

RL-1000-01, m1500, 5800 lm PMMA
 Transopal® (impact strengthened)
 medium beam
 Article no. 325 680 34 21

NORKA

Norddeutsche Kunststoff- und
Elektrogesellschaft Stäcker
mbH & Co. KG
Lichttechnische Spezialfabrik
Sportallee 8
22335 Hamburg
Germany

Postfach 63 02 63
22312 Hamburg
Germany

Phone: +49 40 51 30 09 0
Fax: +49 40 51 30 09 28
Email: info@norka.de
Internet: www.norka.de

Registered office:

Dörverden-Hülsen

Managing Directors:

Dipl.-Ing. (FH) Martin C. Stäcker

Commercial Register:

Walsrode Commercial Register,
part A (HRA) 121059

VAT no.: DE 813 557 992

WEEE: DE 140 338 88

TECHNICAL INFORMATION:

Despite all the care taken in producing and copying these catalogue documents, errors cannot be completely ruled out. We reserve the right to make formal and technical changes. Any measurements, weights and design details are provided without obligation. Figures may vary from the products.

Detailed technical data regarding our products can be obtained from the respective product descriptions/data sheets or requested separately.

DELIVERY TERMS AND CONDITIONS:

All deliveries shall take place in compliance with our General Conditions of Sale.

The current version of the General Sales and Warranty Terms can be found on our homepage at

www.norka.de.

REPRESENTATIVES / WORLDWIDE

Australia

NORKA Lighting Sales Pty. Ltd.
14 Knighton Avenue
Airport West
Melbourne, Victoria 3042
Australia
Tel. +61 393 315 666
Fax +61 393 316 333
www.norkalighting.com.au
andrew@norkalighting.com.au

Austria

LKD Licht Kommunal Digital
GmbH
Münchner Bundesstraße 144
5020 Salzburg
Austria
Tel. +43 662 432 514-0
Fax +43 662 432 514-111
www.lkd.at
office@lkd.at

Belgium

Axioma nv/sa
Mannebeekstraat 31
8790 Waregem
Belgium
Tel. +32 56 622-130
Fax +32 56 622-140
www.axioma.be
info@axioma.be

Czech Republic

Elektrolight CZ s.r.o.
Masná 27/9
602 00 Brno
Czech Republic
Tel. +42 054 532 12 84
Fax +42 054 521 40 20
www.elektrolight.cz
info@elektrolight.cz

Denmark

SafeExit
Herstedøstervej 19
2600 Glostrup
Denmark
Tel. +45 434 550-10
Fax +45 434 550-11
www.safeexit.dk
kontakt@safeexit.dk

Finland

Valoiste Oy
Aleksis Kiven katu 20B
33211 Tampere
Finland
Tel. +35 810 439 17 00
Fax +35 832 220 311
www.valoiste.fi
info@valoiste.fi

France

RIDI France Sàrl
ZI du Forlen
Impasse des Imprimeurs
67118 Geispolsheim
France
Tel. +33 388 77-07 77
Fax +33 388 77-36 99
www.norka-luminaires.fr
info@ridi-france.com

Great Britain

RIDI Lighting Ltd
8/9 The Marshgate Centre
Parkway, Harlow Business Park
Harlow, Essex CM19 5QP
Great Britain
Tel. +44 1279 45 08 82
Fax +44 1279 45 11 69
www.ridi.co.uk
J.Barnard@ridi.co.uk

Greece

Moda Light
17th klm of Athens
Lamia National Highway
145-64 Kifissia Athens
Greece
Tel. +30 210 625 38-02
Fax +30 210 625 38-26
www.modalight.gr
info@modalight.gr

Iceland

Johan Rönnig Ltd.
Klettagarðar 25
104 Reykjavík
Iceland
Tel. +354 5 200 800
Fax +354 5 200 888
www.ronning.is
ronning@ronnng.is

Italy

Regent Illuminazione s.r.l.
Via Vittor Pisani 16
20124 Milan
Italy
Tel. +39 02 667 183 78
Fax +39 02 673 861 09
www.regent.ch
info.it@regent.ch

Luxembourg

Minusines S.A.
8, rue Hogenberg
1022 Luxembourg
Luxembourg
Tel. +35 249 58-58
Fax +35 249 58-66 / 67
www.minusines.lu
info@minusines.lu

Netherlands

Industrielicht B.V.
Van Hennaertweg 7
2952 CA Alblasserdam
Netherlands
Tel. +31 786 92 09-00
Fax +31 786 92 09-05
www.industrielicht.nl
info@industrielicht.nl

Norway

Frizen Belysning
Narviga 7
4633 Kristiansand
Norway
Tel. +47 380 771-00
Fax +47 380 771-01
www.frizen.no
post@frizen.no

Poland

Krulen Spolka z o.o.
Al. Stanów Zjednoczonych 20 A
03-964 Warszawa
Poland
Tel. +48 226 166 054
Fax +48 226 728 109
www.krulen.com.pl
info@krulen.com.pl

Portugal

inolite Iluminación S.L.
Calle Aragón 390 - 394, 3º
08013 Barcelona
Spain
Tel. +34 935 405 066
Fax +34 935 405 066
info@inolite.com
www.inolite.com

Romania

ODRA IMPEX, 95 SRL
Saint Agnes Street no. 206
Popești - Leordeni
77160 Ilfov County
Romania
Tel./Fax +40 213 69 85-22
Tel./Fax +40 213 69 85-21
www.odra.ro
odra@odra.ro

Russia

LIH Light Impex Henze GmbH
Bürgermeister-Schwaiger-
Straße 43
85567 Grafing bei München
Germany
Tel. +49 809 270 995-7
Fax +49 809 270 995-8
www.lih.de
info@lih.de

Slovenia

ES d.o.o.
Ob Zeleni jami 9
1000 Ljubljana
Slovenia
Tel. +38 615 40 16-50
Fax +38 615 40 16-49
www.es-svetila.com
prodaja@es-svetila.com

Spain

inolite Iluminación S.L.
Calle Aragón 390 - 394, 3º
08013 Barcelona
Spain
Tel. +34 935 405 066
Fax +34 935 405 066
info@inolite.com
www.inolite.com

Sweden

Fergin Sverige AB
Bangårdsgatan 9
591 35 Motala
Sweden
Tel. +46 141 500 25
Fax +46 141 536 94
www.fergin.se
info@fergin.se



NORKA

Norddeutsche Kunststoff-
und Elektrogesellschaft
Stäcker mbH & Co. KG

Lichttechnische Spezialfabrik

Contact
Sportallee 8
22335 Hamburg
Germany

P. +49.40.51 30 09-0
F. +49.40.51 30 09-28

info@norka.de
www.norka.de